

Part Number	<b>M7138</b>	Revision
Customer P/N		Revision
Capacitance	<b>40</b> to <b>0.05</b>	uF.
Voltage	<b>250</b>	VAC
Dielectric	<b>Metallized Polypropylene</b>	
Terminal Type	<b>Dual .250" X .03" Quick Connect Terminals</b>	
Operating Temperature	<b>-25</b> to <b>70</b>	°C.
Dissipation Factor	<b>0.01</b>	max. @ 60 Hz.

# MOTOR Capacitors, Inc.

Motor Capacitors, Inc.  
 335 Beinoris Drive  
 Wood Dale, Illinois 60191  
 773-774-6666 (Phone) | 773-774-6690 (Fax)  
[www.capacitorindustries.com](http://www.capacitorindustries.com)  
[info@capacitorindustries.com](mailto:info@capacitorindustries.com)

	Dimension	Tolerance
Diameter (D)	<b>1.42</b>	<b>0.03</b>
Height (L)	<b>4.37</b>	<b>0.03</b>
Quick-Connect Terminal	<b>double</b>	

*Dimensions in inches*

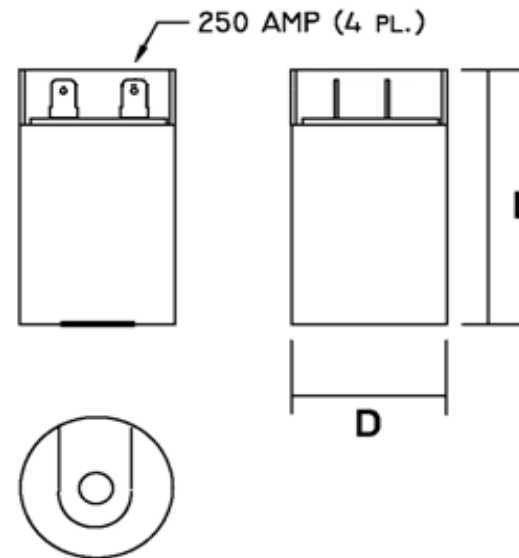

Stamping	<b>JKD-Motor Cap</b>
	<b>M7138</b>
	<b>40 uF. 10% 250 VAC</b>
	<b>~25 ~ +70 C</b>
	<b>Motor Run Capacitor</b>
	<b>RU (datecode) RoHS</b>
	<b>CBB60B</b>



**Terminals must be RECESSED 0.05~0.25" INSIDE of case.**

Engineer JD Aldana  
 Date January 29, 2013