

SEI CAPACITORS

SEI Capacitors, Inc.

335 Beinoris Drive, Wood Dale, IL 60191

Phone: 773-774-6666

Fax: 773-774-6690

www.capacitorindustries.com

CD98SK SERIES

Aluminum Electrolytic Capacitors

- Features:
- Long rated life of 3,000 hours at 85 °C
 - High ripple current
 - Large capacitance
 - Used for car audio system



SPECIFICATION

| | | | | | | | |
|---------------------------------------|--|---|-------------|-----------------|---|--------------------|-----------------------------------|
| Operating Temperature Range (°C) | -40 ~ +85 | | | | | | |
| Rated Voltage Range (V) | 16, 20, 25 | | | | | | |
| Nominal Capacitance Range (uF) | 500,000 ~ 2,000,000 | | | | | | |
| Capacitance Tolerance (20 °C, 120 Hz) | ± 20% | | | | | | |
| Max ESR (mΩ) (20 °C, 120 Hz) | 30 | | | | | | |
| Max Impedance (mΩ) (20 °C, 120 Hz) | 21 | | | | | | |
| Leakage Current (20 °C) | $I \leq 3 \sqrt{CV}$ (uA) (at 20 °C, after 5 minutes) C = Nominal capacitance (uF); V = Rated voltage (V) | | | | | | |
| Load Life (+85 °C) | <table border="1"><tbody><tr><td>Time</td><td>3,000 hours</td></tr><tr><td>Leakage Current</td><td>Not more than the initial specified value</td></tr><tr><td>Capacitance Change</td><td>Within ± 20% of the initial value</td></tr></tbody></table> | Time | 3,000 hours | Leakage Current | Not more than the initial specified value | Capacitance Change | Within ± 20% of the initial value |
| | Time | 3,000 hours | | | | | |
| | Leakage Current | Not more than the initial specified value | | | | | |
| Capacitance Change | Within ± 20% of the initial value | | | | | | |
| Shelf Life (+85 °C) | <table border="1"><tbody><tr><td>Time</td><td>1,000 hours</td></tr><tr><td>Leakage Current</td><td>Not more than the initial specified value</td></tr><tr><td>Capacitance Change</td><td>Within ± 20% of the initial value</td></tr></tbody></table> | Time | 1,000 hours | Leakage Current | Not more than the initial specified value | Capacitance Change | Within ± 20% of the initial value |
| | Time | 1,000 hours | | | | | |
| | Leakage Current | Not more than the initial specified value | | | | | |
| Capacitance Change | Within ± 20% of the initial value | | | | | | |

SEI-CAPACITORS

SEI Capacitors, Inc.

335 Beinoris Drive, Wood Dale, IL 60191

Phone: 773-774-6666

Fax: 773-774-6690

www.capacitorindustries.com

DIMENSIONS

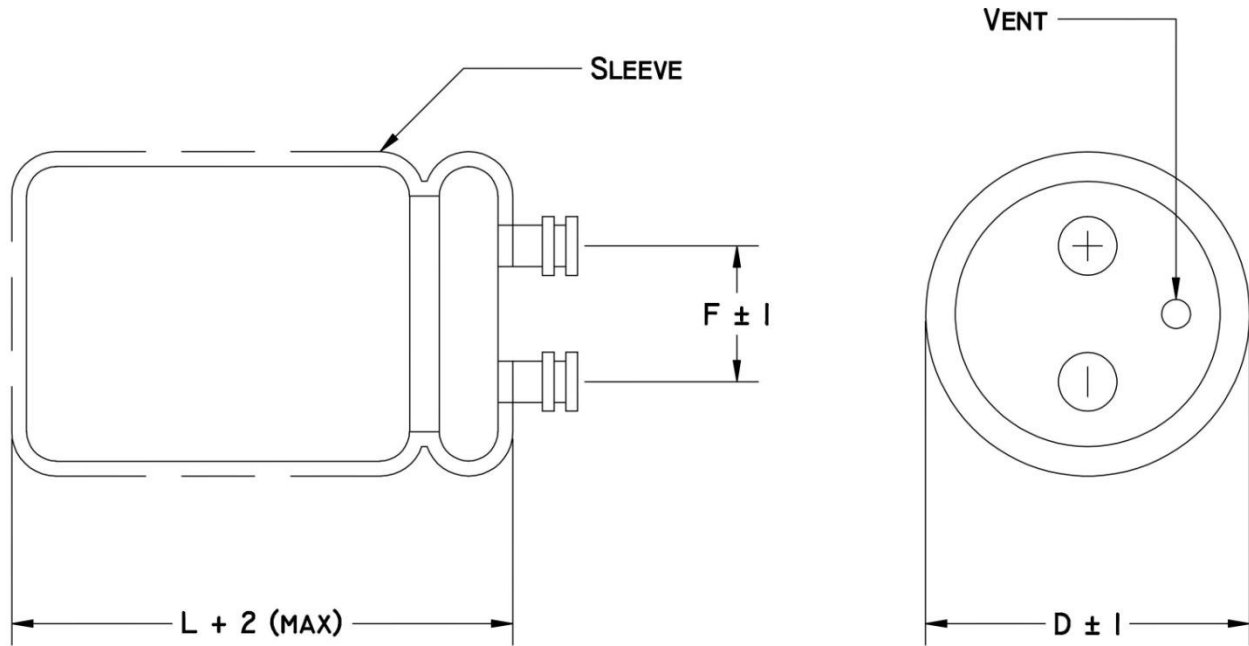

Dimensions are in millimeters (mm)

| | | | |
|---|----|----|-----|
| D | 76 | 89 | 100 |
| F | 32 | 32 | 32 |

STANDARD RATINGS

| uF \ WV | 16 | | | 20 | | | 25 | | |
|-----------|------------|------------|--------------------|------------|------------|--------------------|------------|------------|--------------------|
| | D x L (mm) | Ripple (A) | Dissipation Factor | D x L (mm) | Ripple (A) | Dissipation Factor | D x L (mm) | Ripple (A) | Dissipation Factor |
| 500,000 | 76 x 110 | 32 | 1.5 | 76 x 110 | 33 | 1.5 | 76 x 155 | 35 | 1.5 |
| 800,000 | 76 x 155 | 38 | 2.0 | 76 x 220 | 39 | 2.0 | 89 x 157 | 40 | 2.0 |
| 1,000,000 | 76 x 220 | 40 | 2.5 | 89 x 157 | 42 | 2.5 | 89 x 196 | 45 | 2.5 |
| 1,200,000 | 76 x 220 | 45 | 2.5 | 89 x 196 | 47 | 2.5 | 89 x 196 | 50 | 2.5 |
| 1,500,000 | 89 x 196 | 48 | 3.0 | 89 x 236 | 50 | 3.0 | 89 x 236 | 56 | 3.0 |
| 2,000,000 | 89 x 236 | 56 | 3.0 | 100 x 236 | 58 | 3.0 | 100 x 236 | 62 | 3.0 |

Ripple Current: 85 °C, 100 Hz or 120 Hz.

Specific capacitance and case sizes are available upon request.