

SEI CAPACITORS

SEI Capacitors, Inc.

335 Beinoris Drive, Wood Dale, IL 60191

Phone: 773-774-6666

Fax: 773-774-6690

www.capacitorindustries.com

CD92L SERIES

Aluminum Electrolytic Capacitors

- Features:
- Long rated life of 2,000 hours at 85 °C
 - High ripple current
 - Extremely low impedance



SPECIFICATION

Operating Temperature Range (°C)	-40 ~ +85							
Rated Voltage Range (V)	10 ~ 100							
Nominal Capacitance Range (µF)	1,000 ~ 220,000							
Capacitance Tolerance (20 °C, 120 Hz)	± 20%							
Leakage Current (20 °C)	$I \leq 0.006CV + 4 \text{ (}\mu\text{A) or } 5 \text{ mA}$ (whichever is smaller; after 5 minutes) C = Nominal capacitance (µF); V = Rated voltage (V)							
Dissipation Factor (20 °C, 120 Hz)	Rated Voltage (V)	10	16	25	50	63	100	
	D.F.	D=35	0.50	0.40	0.30	0.25	0.20	0.15
		D=50	0.75	0.50	0.40	0.30	0.25	0.20
		D=64	1.00	0.75	0.50	0.35	0.30	0.25
D=76		1.50	1.00	0.75	0.50	0.40	0.35	
Load Life (+85 °C)	Time	2,000 hours						
	Leakage Current	Not more than the initial specified value						
	Capacitance Change	Within ± 20% of the initial value						
	Dissipation Factor	Not more than 200% of the specified value						
Shelf Life (+85 °C)	Time	500 hours						
	Leakage Current	Not more than the initial specified value						
	Capacitance Change	Within ± 15% of the initial value						
	Dissipation Factor	Not more than 150% of the specified value						

SEI CAPACITORS

SEI Capacitors, Inc.

335 Beinoris Drive, Wood Dale, IL 60191

Phone: 773-774-6666

Fax: 773-774-6690

www.capacitorindustries.com

DIMENSIONS

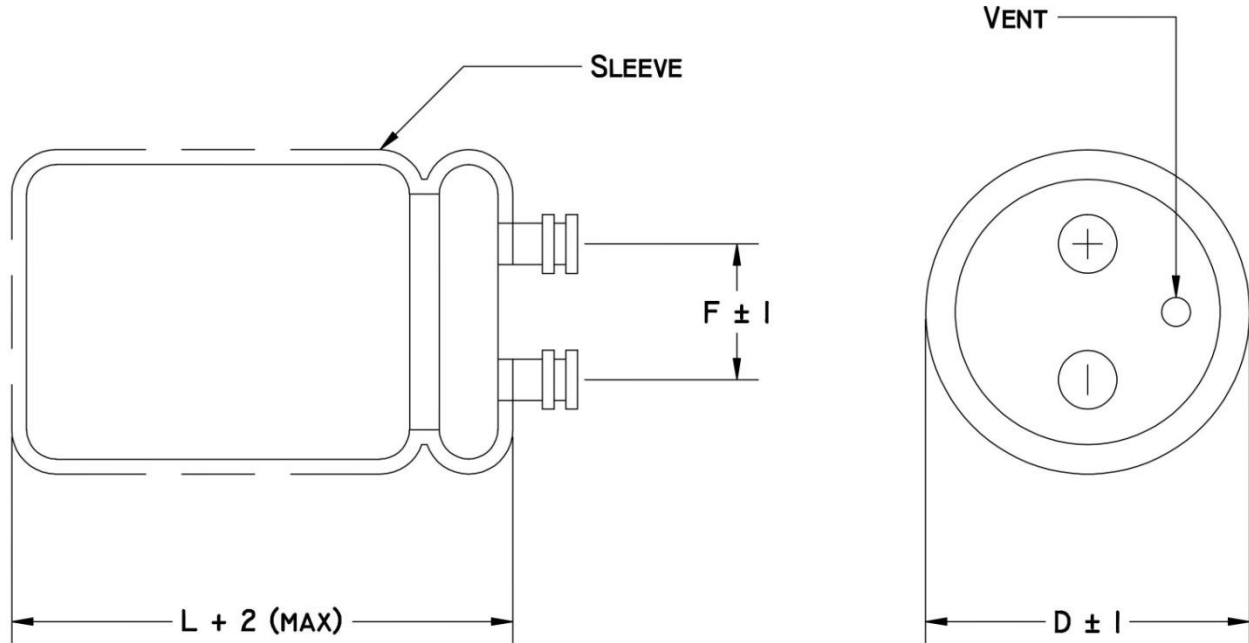

Dimensions are in millimeters (mm)

D	35	50	64	76
F	12.7	21.8	28.2	31.4

RIPPLE CURRENT MULTIPLIER

Frequency (Hz)	50	100	400	1K	20K
Coefficient	0.7	1.0	1.08	1.10	1.15

Frequency Coefficient

SEI CAPACITORS

SEI Capacitors, Inc.

335 Beinoris Drive, Wood Dale, IL 60191

Phone: 773-774-6666

Fax: 773-774-6690

www.capacitorindustries.com

STANDARD RATINGS

uF \ WV	10			16			25		
	Size D x L (mm)	Impedance Z (mOhm)	Ripple (A)	Size D x L (mm)	Impedance Z (mOhm)	Ripple (A)	Size D x L (mm)	Impedance Z (mOhm)	Ripple (A)
1,000	-	-	-	-	-	-	-	-	-
1,500	-	-	-	-	-	-	-	-	-
2,200	-	-	-	-	-	-	-	-	-
3,300	-	-	-	-	-	-	-	-	-
4,700	-	-	-	-	-	-	35 X 60	23	5.2
6,800	-	-	-	-	-	-	35 X 60	21	5.2
10,000	-	-	-	35 X 60	20	6	35 X 80	15	6.7
15,000	35 X 60	20	6	35 X 80	14	7.5	35 X 100	11	9.7
22,000	35 X 80	14	7.5	35 X 100	10	10	50 X 80	9.5	12.5
33,000	35 X 100	10	10	50 X 80	9.5	13	50 X 100	8.0	18
47,000	50 X 80	9.5	14	50 X 100	8.0	18	64 X 100	5.0	27
68,000	50 X 100	8.0	18	64 X 100	5.0	28	64 X 100	5.0	27
100,000	64 X 100	5.0	30	64 X 100	5.0	28	76 X 100	4.0	37
150,000	64 X 100	5.0	30	76 X 100	4.0	37	-	-	-
220,000	76 X 100	4.0	37	-	-	-	-	-	-

uF \ WV	50			63			100		
	Size D x L (mm)	Impedance Z (mOhm)	Ripple (A)	Size D x L (mm)	Impedance Z (mOhm)	Ripple (A)	Size D x L (mm)	Impedance Z (mOhm)	Ripple (A)
1,000	-	-	-	-	-	-	35 X 60	67	3.0
1,500	-	-	-	-	-	-	35 X 60	60	3.3
2,200	-	-	-	35 X 60	33	3.7	35 X 80	42	4.6
3,300	35 X 60	32	4.5	35 X 60	30	3.7	35 X 100	28	6.5
4,700	35 X 60	33	4.5	35 X 80	21	5.2	50 X 80	25	7.4
6,800	35 X 80	23	6	35 X 100	15	7.5	50 X 100	18	9.9
10,000	35 X 100	17	7.5	50 X 80	14	9.5	64 X 100	11	15.0
15,000	50 X 80	13	10	50 X 100	10.5	13.5	64 X 100	10	15.8
22,000	50 X 100	10.5	15	64 X 100	6.0	21	76 X 100	8	20.5
33,000	64 X 100	6.0	21	64 X 100	6.0	22	-	-	-
47,000	64 X 100	6.0	22	76 X 100	4.5	30	-	-	-
68,000	76 X 100	4.5	30	-	-	-	-	-	-

Ripple Current: 85 °C, 100 Hz or 120 Hz; Impedance: 20 °C, 20 KHz.

Specific capacitance and case sizes are available upon request.