

SEI CAPACITORS

SEI Capacitors, Inc.

335 Beinoris Drive, Wood Dale, IL 60191

Phone: 773-774-6666

Fax: 773-774-6690

www.capacitorindustries.com

CD92H SERIES

Aluminum Electrolytic Capacitors

- Features:
- Rated life of 1,000 hours at 105 °C
 - Large capacitance, wide temperature
 - Low dissipation factor, small size
 - Low leakage current, high ripple current



SPECIFICATION

Operating Temperature Range (°C)	-40 ~ +105																																										
Rated Voltage Range (V)	10 ~ 100																																										
Nominal Capacitance Range (uF)	2,200 ~ 470,000																																										
Capacitance Tolerance (20 °C, 120 Hz)	± 20%																																										
Leakage Current (20 °C)	D = 35mm: I ≤ 0.02CV or 3 mA (whichever is smaller)	D ≥ 50mm: I ≤ 0.03CV or 5 mA (whichever is smaller)																																									
	C = Nominal capacitance (uF); V = Rated voltage (V)																																										
Dissipation Factor (20 °C, 120 Hz)	<table border="1"> <thead> <tr> <th>Rated Voltage (V)</th> <th>10</th> <th>16</th> <th>25</th> <th>35 ~ 63</th> <th>80</th> <th>100</th> </tr> </thead> <tbody> <tr> <td rowspan="4">D.F.</td> <td>D=35</td> <td>0.75</td> <td>0.50</td> <td>0.35</td> <td>0.25</td> <td>0.25</td> <td>0.25</td> </tr> <tr> <td>D=50</td> <td>1.00</td> <td>0.75</td> <td>0.50</td> <td>0.35</td> <td>0.30</td> <td>0.25</td> </tr> <tr> <td>D=65</td> <td>1.50</td> <td>1.00</td> <td>0.75</td> <td>0.50</td> <td>0.35</td> <td>0.35</td> </tr> <tr> <td>D=80</td> <td>2.00</td> <td>1.50</td> <td>0.75</td> <td>0.50</td> <td>0.40</td> <td>0.35</td> </tr> </tbody> </table>							Rated Voltage (V)	10	16	25	35 ~ 63	80	100	D.F.	D=35	0.75	0.50	0.35	0.25	0.25	0.25	D=50	1.00	0.75	0.50	0.35	0.30	0.25	D=65	1.50	1.00	0.75	0.50	0.35	0.35	D=80	2.00	1.50	0.75	0.50	0.40	0.35
	Rated Voltage (V)	10	16	25	35 ~ 63	80	100																																				
	D.F.	D=35	0.75	0.50	0.35	0.25	0.25	0.25																																			
		D=50	1.00	0.75	0.50	0.35	0.30	0.25																																			
D=65		1.50	1.00	0.75	0.50	0.35	0.35																																				
D=80		2.00	1.50	0.75	0.50	0.40	0.35																																				
Load Life (+105 °C)	Time		1,000 hours																																								
	Leakage Current		Not more than the initial specified value																																								
	Capacitance Change		Within ± 15% of the initial value																																								
	Dissipation Factor		Not more than 200% of the specified value																																								
Shelf Life (+105 °C)	Time		500 hours																																								
	Leakage Current		Not more than the initial specified value																																								
	Capacitance Change		Within ± 15% of the initial value																																								
	Dissipation Factor		Not more than 200% of the specified value																																								

SEI-CAPACITORS

SEI Capacitors, Inc.

335 Beinoris Drive, Wood Dale, IL 60191

Phone: 773-774-6666

Fax: 773-774-6690

www.capacitorindustries.com

DIMENSIONS

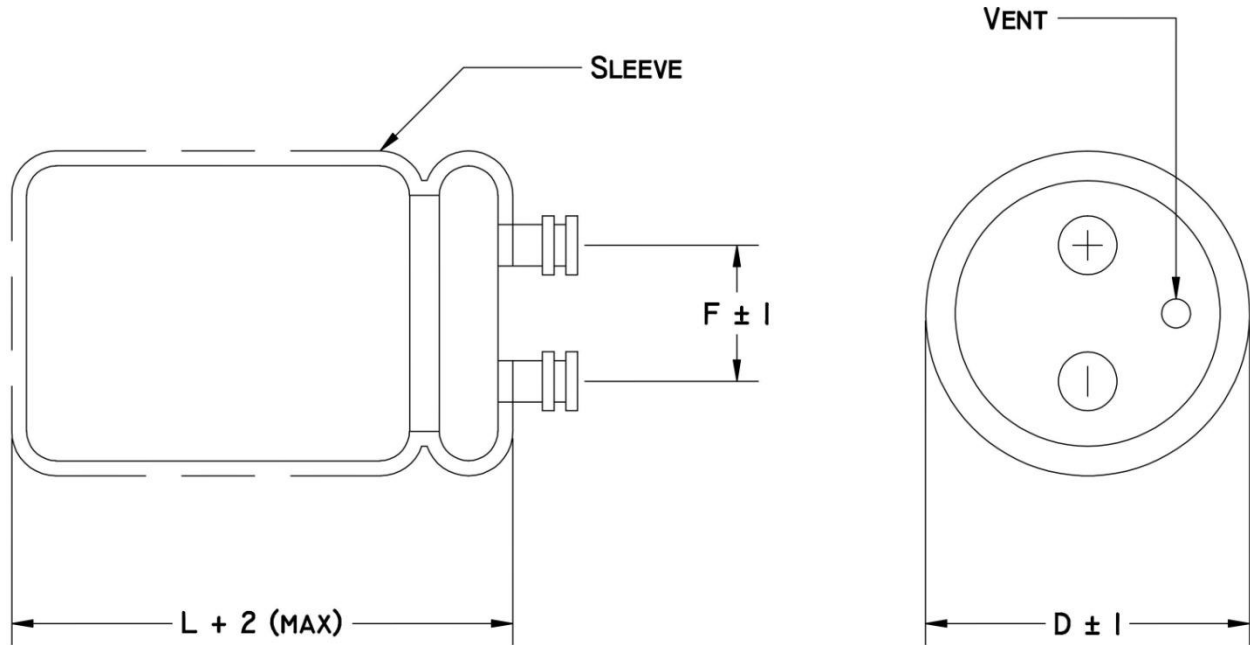

Dimensions are in millimeters (mm)

D	35	50	64	76
F	12.7	21.8	28.2	31.4

SEI CAPACITORS

SEI Capacitors, Inc.

335 Beinoris Drive, Wood Dale, IL 60191

Phone: 773-774-6666

Fax: 773-774-6690

www.capacitorindustries.com

STANDARD RATINGS

WV uF	10		16		25		35		50		63		80		100	
	DxL (mm)	Ripple (A)	DxL (mm)	Ripple (A)	DxL (mm)	Ripple (A)	DxL (mm)	Ripple (A)	DxL (mm)	Ripple (A)	DxL (mm)	Ripple (A)	DxL (mm)	Ripple (A)	DxL (mm)	Ripple (A)
2,200															35x50	2.1
3,300															35x80	3.0
4,700											35x50	3.0	35x80	3.4	35x100	3.9
6,800								35x50	3.6	35x60	3.9	35x80	4.3	35x120	4.9	
10,000							35x50	4.3	35x60	4.7	35x80	5.1	35x100 35x80	4.2 6.0	50x80	6.0
15,000					35x50	4.4	35x80	6.2	35x80	6.2	35x100	6.7	50x100	7.0	50x120	8.3
22,000			35x50	4.5	35x80	6.3	35x100	8.0	35x80	7.3	50x80	7.4	65x100	7.8	65x120	9.1
33,000	35x50	4.2	35x80	6.4	35x100	8.3	35x80	9.0	50x80	9.0	50x100	9.7	80x100	10.5	80x120	12.0
47,000	35x80	6.2	35x100	8.2	35x80	8.9	50x80	11.5	50x100	11.5	60x100	10.5	80x120	13.5		
68,000	35x100	8.0	35x120	10.5	50x80	10.8	50x120	14.6	65x100	12.7	65x120	13.4				
100,000	35x120	10.4	50x80	10.7	50x120	14.8	65x100	15.4	80x120	16.6						
150,000	50x80	11.3	50x120	14.8	65x120	16.2	65x120	21.4								
220,000	50x120	15.5	65x120	17.0	80x120	21.2										
330,000	65x120	17.0	80x120	22.5												
470,000	80x120	21.9														

Ripple Current: 85 °C, 100 Hz or 120 Hz.

Specific capacitance and case sizes are available upon request.