

SEI CAPACITORS

SEI Capacitors, Inc.

335 Beinoris Drive, Wood Dale, IL 60191

Phone: 773-774-6666

Fax: 773-774-6690

www.capacitorindustries.com

CD92 SERIES

Aluminum Electrolytic Capacitors

- Features:
- Rated life of 1,000 hours at 85 °C
 - Low voltage, large capacitance
 - Low dissipation factor, small size
 - Low leakage current, high ripple current



SPECIFICATION

Operating Temperature Range (°C)	-40 ~ +85																																									
Rated Voltage Range (V)	10 ~ 100																																									
Nominal Capacitance Range (uF)	2,200 ~ 470,000																																									
Capacitance Tolerance (20 °C, 120 Hz)	± 20%																																									
Leakage Current (20 °C)	D = 35mm: I ≤ 0.02CV or 3 mA (whichever is smaller)	D ≥ 50mm: I ≤ 0.03CV or 5 mA (whichever is smaller)																																								
	C = Nominal capacitance (uF); V = Rated voltage (V)																																									
Dissipation Factor (20 °C, 120 Hz)	<table border="1"> <thead> <tr> <th>Rated Voltage (V)</th> <th>10</th> <th>16</th> <th>25</th> <th>35 ~ 63</th> <th>80</th> <th>100</th> </tr> </thead> <tbody> <tr> <td>D=35</td> <td>0.75</td> <td>0.50</td> <td>0.35</td> <td>0.25</td> <td>0.25</td> <td>0.25</td> </tr> <tr> <td>D=50</td> <td>1.00</td> <td>0.75</td> <td>0.50</td> <td>0.35</td> <td>0.30</td> <td>0.25</td> </tr> <tr> <td>D=65</td> <td>1.50</td> <td>1.00</td> <td>0.75</td> <td>0.50</td> <td>0.35</td> <td>0.35</td> </tr> <tr> <td>D=80</td> <td>2.00</td> <td>1.50</td> <td>0.75</td> <td>0.50</td> <td>0.40</td> <td>0.35</td> </tr> </tbody> </table>							Rated Voltage (V)	10	16	25	35 ~ 63	80	100	D=35	0.75	0.50	0.35	0.25	0.25	0.25	D=50	1.00	0.75	0.50	0.35	0.30	0.25	D=65	1.50	1.00	0.75	0.50	0.35	0.35	D=80	2.00	1.50	0.75	0.50	0.40	0.35
	Rated Voltage (V)	10	16	25	35 ~ 63	80	100																																			
	D=35	0.75	0.50	0.35	0.25	0.25	0.25																																			
	D=50	1.00	0.75	0.50	0.35	0.30	0.25																																			
D=65	1.50	1.00	0.75	0.50	0.35	0.35																																				
D=80	2.00	1.50	0.75	0.50	0.40	0.35																																				
Load Life (+85 °C)	<table border="1"> <thead> <tr> <th>Time</th> <th>1,000 hours</th> </tr> </thead> <tbody> <tr> <td>Leakage Current</td> <td>Not more than the initial specified value</td> </tr> <tr> <td>Capacitance Change</td> <td>Within ± 15% of the initial value</td> </tr> <tr> <td>Dissipation Factor</td> <td>Not more than 200% of the specified value</td> </tr> </tbody> </table>		Time	1,000 hours	Leakage Current	Not more than the initial specified value	Capacitance Change	Within ± 15% of the initial value	Dissipation Factor	Not more than 200% of the specified value																																
	Time	1,000 hours																																								
	Leakage Current	Not more than the initial specified value																																								
	Capacitance Change	Within ± 15% of the initial value																																								
Dissipation Factor	Not more than 200% of the specified value																																									
Shelf Life (+85 °C)	<table border="1"> <thead> <tr> <th>Time</th> <th>500 hours</th> </tr> </thead> <tbody> <tr> <td>Leakage Current</td> <td>Not more than the initial specified value</td> </tr> <tr> <td>Capacitance Change</td> <td>Within ± 15% of the initial value</td> </tr> <tr> <td>Dissipation Factor</td> <td>Not more than 200% of the specified value</td> </tr> </tbody> </table>		Time	500 hours	Leakage Current	Not more than the initial specified value	Capacitance Change	Within ± 15% of the initial value	Dissipation Factor	Not more than 200% of the specified value																																
	Time	500 hours																																								
	Leakage Current	Not more than the initial specified value																																								
	Capacitance Change	Within ± 15% of the initial value																																								
Dissipation Factor	Not more than 200% of the specified value																																									

SEI-CAPACITORS

SEI Capacitors, Inc.

335 Beinoris Drive, Wood Dale, IL 60191

Phone: 773-774-6666

Fax: 773-774-6690

www.capacitorindustries.com

DIMENSIONS

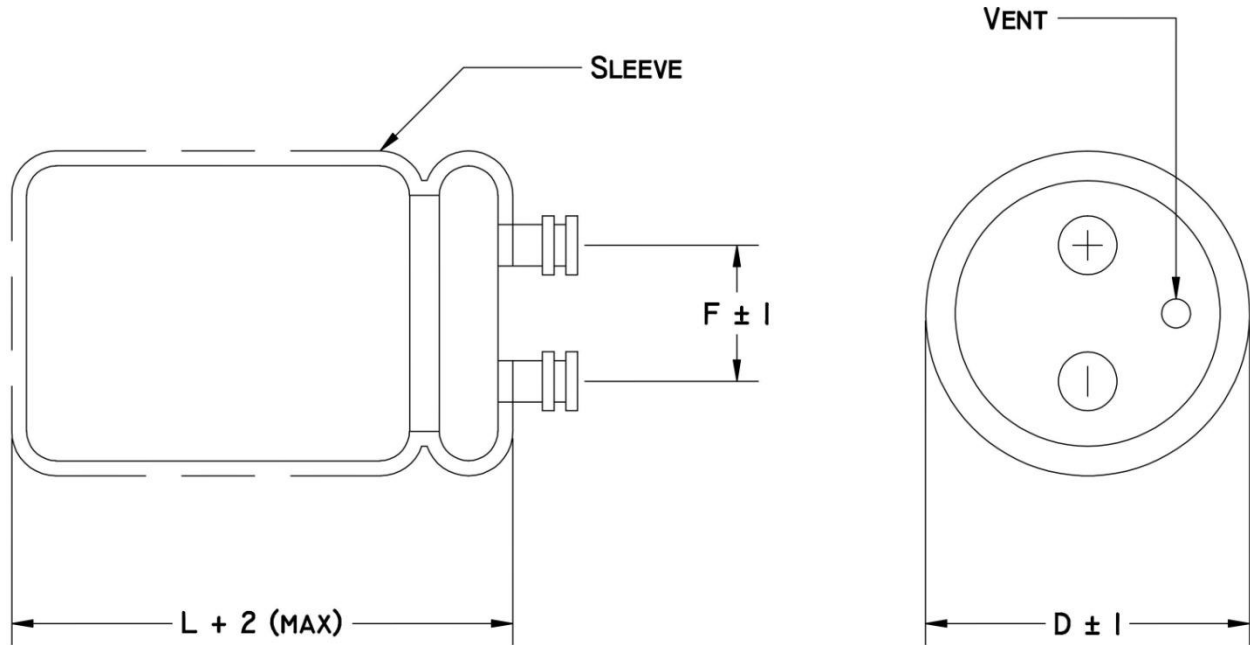

Dimensions are in millimeters (mm)

D	35	50	64	76
F	12.7	21.8	28.2	31.4

SEI CAPACITORS

SEI Capacitors, Inc.

335 Beinoris Drive, Wood Dale, IL 60191

Phone: 773-774-6666

Fax: 773-774-6690

www.capacitorindustries.com

STANDARD RATINGS

WV uF	10		16		25		35		50		63		80		100	
	DxL (mm)	Ripple (A)	DxL (mm)	Ripple (A)	DxL (mm)	Ripple (A)	DxL (mm)	Ripple (A)	DxL (mm)	Ripple (A)	DxL (mm)	Ripple (A)	DxL (mm)	Ripple (A)	DxL (mm)	Ripple (A)
2,200	-	-	-	-	-	-	-	-	-	-	-	-	-	-	35x50	2.1
3,300															35x80	3.0
4,700	-	-	-	-	-	-	-	-	-	-	35x50	3.0	35x80	3.4	35x100	3.9
6,800	-	-	-	-	-	-	-	-	35x50	3.6	35x60	3.9	35x80	4.3	35x120	4.9
10,000	-	-	-	-	-	-	35x50	4.3	35x60	4.7	35x80	5.1	35x80	6.0	50x80	6.0
15,000	-	-	-	-	35x50	4.4	35x80	6.2	35x80	6.2	35x100	6.7	50x100	7.0	50x120	8.3
22,000	-	-	35x50	4.5	35x80	6.3	35x100	8.0	35x80	7.3	50x80	7.4	65x100	7.8	65x120	9.1
33,000	35x50	4.2	35x80	6.4	35x100	8.3	35x80	9.0	50x80	9.0	50x100	9.7	80x100	10.5	80x120	12.0
47,000	35x80	6.2	35x100	8.2	35x80	8.9	50x80	11.5	50x100	11.5	60x100	10.5	80x120	13.5	-	-
68,000	35x100	8.0	35x120	10.5	50x80	10.8	50x120	14.6	65x100	12.7	65x120	13.4	-	-	-	-
100,000	35x120	10.4	50x80	10.7	50x120	14.8	65x100	15.4	80x120	16.6	-	-	-	-	-	-
150,000	50x80	11.3	50x120	14.8	65x120	16.2	65x120	21.4	-	-	-	-	-	-	-	-
220,000	50x120	15.5	65x120	17.0	80x120	21.2	-	-	-	-	-	-	-	-	-	-
330,000	65x120	17.0	80x120	22.5	-	-	-	-	-	-	-	-	-	-	-	-
470,000	80x120	21.9	-	-	-	-	-	-	-	-	-	-	-	-	-	-

Ripple Current: 85 °C, 100 Hz or 120 Hz.

Specific capacitance and case sizes are available upon request.