

SEI • CAPACITORS

SEI Capacitors, Inc.

335 Beinoris Drive, Wood Dale, IL 60191

Phone: 773-774-6666

Fax: 773-774-6690

www.capacitorindustries.com

CD13NH SERIES

Aluminum Electrolytic Capacitors

- Features:
- Long rated life of 2,000 hours at 105 °C
 - High ripple current
 - Used for computers powers, hi-ripple circuit of electric vehicle, electric train, general-purpose inverter, etc.



SPECIFICATION

| | | | |
|---------------------------------------|--|---|-----------|
| Operating Temperature Range (°C) | -25 ~ +105 | | |
| Rated Voltage Range (V) | 160 ~ 450 | | |
| Nominal Capacitance Range (uF) | 270 ~ 39,000 | | |
| Capacitance Tolerance (20 °C, 120 Hz) | ± 20% | | |
| Leakage Current (uA) | $I \leq 0.02CV$ or 5 mA, whichever is smaller (at 20 °C, after 5 minutes) C = Nominal capacitance (uF); V = Rated voltage (V) | | |
| Dissipation Factor (20 °C, 120 Hz) | Rated Voltage (V) | 160 ~ 250 | 350 ~ 450 |
| | D.F. | 0.25 | 0.20 |
| Load Life (+105 °C) | Time | 2,000 hours | |
| | Leakage Current | Not more than the initial specified value | |
| | Capacitance Change | Within ± 20% of the initial value | |
| | Dissipation Factor | Not more than 200% of the specified value | |
| Shelf Life (+105 °C) | Time | 500 hours | |
| | Leakage Current | Not more than the initial specified value | |
| | Capacitance Change | Within ± 20% of the initial value | |
| | Dissipation Factor | Not more than 200% of the specified value | |

SEI CAPACITORS

SEI Capacitors, Inc.

335 Beinoris Drive, Wood Dale, IL 60191

Phone: 773-774-6666

Fax: 773-774-6690

www.capacitorindustries.com

DIMENSIONS

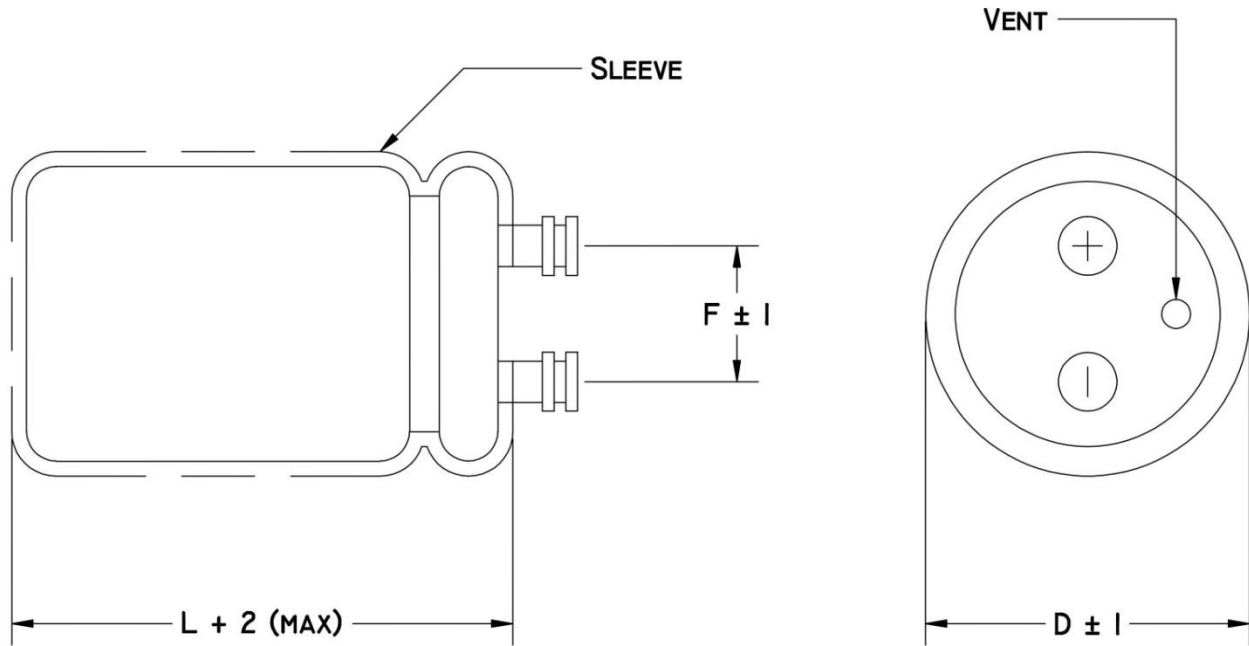

Dimensions are in millimeters (mm)

| | | | | | |
|---|----|----|----|----|----|
| D | 35 | 50 | 65 | 76 | 89 |
| F | 13 | 22 | 28 | 32 | 32 |

RIPPLE CURRENT MULTIPLIER

| | | | | | |
|----------------|--------|-----|------|------|-------|
| Frequency (Hz) | 50, 60 | 120 | 300 | 1K | ≥ 10K |
| Coefficient | 0.7 | 1.0 | 1.10 | 1.30 | 1.40 |

Frequency Coefficient

| | | | |
|------------------|-----|-----|------|
| Temperature (°C) | +70 | +85 | +105 |
| Coefficient | 2.1 | 1.7 | 1.0 |

Temperature Coefficient

SEI CAPACITORS

SEI Capacitors, Inc.

335 Beinoris Drive, Wood Dale, IL 60191

Phone: 773-774-6666

Fax: 773-774-6690

www.capacitorindustries.com

STANDARD RATINGS

| WV uF | 160 | | 200 | | 250 | | 350 | | 400 | | 450 | |
|----------|------------|------------|------------|------------|------------|------------|------------|------------|------------|------------|------------|------------|
| | D x L (mm) | Ripple (A) | D x L (mm) | Ripple (A) | D x L (mm) | Ripple (A) | D x L (mm) | Ripple (A) | D x L (mm) | Ripple (A) | D x L (mm) | Ripple (A) |
| 270 | | | | | | | | | | | 35x53 | 3.7 |
| 330 | | | | | | | | | 35x53 | 4.1 | 35x83 | 4.9 |
| 389 | | | | | | | 35x53 | 4.5 | 35x83 | 5.3 | 35x83 | 4.3 |
| 470 | | | | | | | 35x83 | 5.8 | 35x83 | 5.8 | 35x83 | 5.6 |
| 560 | | | | | | | 35x83 | 6.4 | 35x100 | 6.4 | 35x100 | 6.9 |
| 680 | | | | | | | 35x83 | 7.0 | 35x100 | 7.6 | 35x100 | 7.6 |
| 820 | | | | | | | 35x100 | 8.3 | 35x100 | 8.3 | 50x75 | 8.6 |
| 1,000 | | | | | | | 50x75 | 9.2 | 50x75 | 9.4 | 50x75 | 9.4 |
| 1,200 | | | | | | | 50x75 | 10.3 | 50x75 | 10.3 | 50x96 | 11.4 |
| 1,500 | | | | | 35x100 | 8.7 | 50x96 | 11.5 | 50x96 | 12.7 | 50x115 | 13.7 |
| 1,800 | | | | | 35x100 | 9.5 | 50x96 | 13.9 | 50x96 | 13.9 | 50x130 | 15.8 |
| 2,200 | | | 35x100 | 10.6 | 50x75 | 10.8 | 50x130 | 15.4 | 50x115 | 17.4 | 65x96 | 17.0 |
| 2,700 | | | 35x121 | 12.7 | 50x75 | 12.0 | 50x130 | 19.3 | 50x130 | 18.8 | 65x110 | 20.2 |
| 3,300 | 35x121 | 14.0 | 50x75 | 13.3 | 50x96 | 14.6 | 65x115 | 21.4 | 65x115 | 22.2 | 65x130 | 23.4 |
| 3,890 | 50x75 | 14.4 | 50x75 | 14.4 | 50x115 | 17.0 | 65x130 | 24.2 | 65x130 | 25.4 | 76x110 | 25.6 |
| 4,700 | 50x75 | 15.8 | 50x96 | 17.4 | 65x96 | 19.2 | 65x130 | 27.9 | 65x130 | 28.2 | 76x130 | 29.4 |
| 5,600 | 50x96 | 19.0 | 50x115 | 20.4 | 65x96 | 21.0 | 76x115 | 30.7 | 76x130 | 32.2 | 76x157 | 34.6 |
| 6,800 | 50x96 | 21.0 | 50x130 | 12.7 | 65x115 | 24.7 | 76x155 | 35.4 | 76x155 | 38.0 | 89x157 | 40.5 |
| 8,200 | 50x115 | 24.7 | 65x96 | 25.4 | 65x115 | 27.1 | 76x155 | 41.7 | 89x157 | 44.4 | 89x157 | 44.6 |
| 10,000 | 65x96 | 28.0 | 65x96 | 28.0 | 65x130 | 31.5 | 89x157 | 49.0 | 89x157 | 49.4 | 89x196 | 53.9 |
| 12,000 | 65x96 | 30.6 | 76x96 | 32.6 | 76x115 | 34.8 | 89x157 | 54.1 | 89x196 | 59.1 | 89x236 | 63.8 |
| 15,000 | 65x130 | 38.6 | 76x96 | 39.0 | 76x130 | 40.8 | 89x196 | 66.2 | 89x236 | 71.1 | | |
| 18,000 | 65x130 | 42.2 | 76x130 | 44.6 | 76x155 | 57.8 | 86x236 | 76.9 | | | | |
| 22,000 | 76x130 | 49.4 | 76x155 | 53.0 | 89x157 | 56.5 | | | | | | |
| 27,000 | 76x130 | 54.7 | 89x131 | 58.2 | | | | | | | | |
| 33,000 | 89x131 | 65.2 | 89x157 | 69.0 | | | | | | | | |
| 39,000 | 90x157 | 75.3 | | | | | | | | | | |

Ripple Current: +45 °C, 100 Hz or 120 Hz
 Specific capacitance and case sizes are available upon request.