

SEI CAPACITORS

SEI Capacitors, Inc.

335 Beinoris Drive, Wood Dale, IL 60191

Phone: 773-774-6666

Fax: 773-774-6690

www.capacitorindustries.com

CD13HL SERIES

Aluminum Electrolytic Capacitors

- Features:
- Long rated life of 5,000 hours at 105 °C
 - Wide temperature



SPECIFICATION

Operating Temperature Range (°C)	-40 ~ +105								
Rated Voltage Range (V)	350, 400, 450								
Nominal Capacitance Range (µF)	1,000 ~ 15,000								
Capacitance Tolerance (20 °C, 120 Hz)	± 20%								
Leakage Current (µA)	$I \leq 0.01CV$ or 5 mA, whichever is smaller (at 20 °C, after 5 minutes) C = Nominal capacitance (µF); V = Rated voltage (V)								
Dissipation Factor (20 °C, 120 Hz)	≤ 0.15								
Load Life (+105 °C)	<table border="1"><thead><tr><th>Time</th><th>5,000 hours</th></tr></thead><tbody><tr><td>Leakage Current</td><td>Not more than the initial specified value</td></tr><tr><td>Capacitance Change</td><td>Within ± 15% of the initial value</td></tr><tr><td>Dissipation Factor</td><td>Not more than 175% of the specified value</td></tr></tbody></table>	Time	5,000 hours	Leakage Current	Not more than the initial specified value	Capacitance Change	Within ± 15% of the initial value	Dissipation Factor	Not more than 175% of the specified value
	Time	5,000 hours							
	Leakage Current	Not more than the initial specified value							
	Capacitance Change	Within ± 15% of the initial value							
Dissipation Factor	Not more than 175% of the specified value								
Shelf Life (+105 °C)	<table border="1"><thead><tr><th>Time</th><th>1,000 hours</th></tr></thead><tbody><tr><td>Leakage Current</td><td>Not more than the initial specified value</td></tr><tr><td>Capacitance Change</td><td>Within ± 15% of the initial value</td></tr><tr><td>Dissipation Factor</td><td>Not more than 175% of the specified value</td></tr></tbody></table>	Time	1,000 hours	Leakage Current	Not more than the initial specified value	Capacitance Change	Within ± 15% of the initial value	Dissipation Factor	Not more than 175% of the specified value
	Time	1,000 hours							
	Leakage Current	Not more than the initial specified value							
	Capacitance Change	Within ± 15% of the initial value							
Dissipation Factor	Not more than 175% of the specified value								

SEI CAPACITORS

SEI Capacitors, Inc.

335 Beinoris Drive, Wood Dale, IL 60191

Phone: 773-774-6666

Fax: 773-774-6690

www.capacitorindustries.com

DIMENSIONS

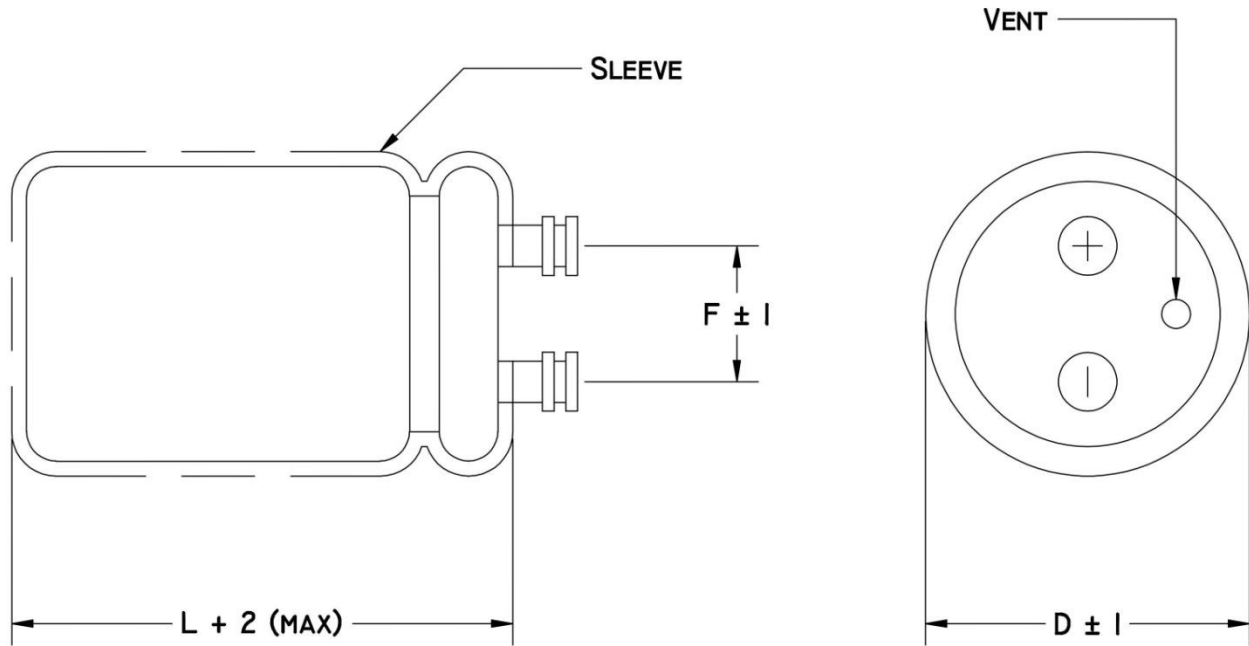

Dimensions are in millimeters (mm)

D	51	64	77	90
F	22	28.6	32	32

RIPPLE CURRENT MULTIPLIER

Frequency (Hz)	50, 60	120	300	1K	$\geq 10K$
Coefficient	0.7	1.0	1.10	1.30	1.40

Frequency Coefficient

Temperature (°C)	+40	+60	+70	+85
Coefficient	2.44	2.16	2.00	2.00

Temperature Coefficient

SEI CAPACITORS

SEI Capacitors, Inc.

335 Beinoris Drive, Wood Dale, IL 60191

Phone: 773-774-6666

Fax: 773-774-6690

www.capacitorindustries.com

STANDARD RATINGS

uF \ WV	350		400		450	
	D x L (mm)	Ripple (A)	D x L (mm)	Ripple (A)	D x L (mm)	Ripple (A)
1000	51 x 75	3.9	51 x 75	3.9	51 x 96	4.2
1200	51 x 75	4.2	51 x 96	4.6	51 x 115	5.0
1500	51 x 96	5.2	51 x 115	5.6	51 x 130	5.9
1800	51 x 96	5.7	51 x 130	6.4	64 x 96	6.3
2200	51 x 130	7.1	64 x 96	6.9	64 x 115	7.4
2700	64 x 96	7.7	64 x 115	8.2	64 x 130	8.6
					77 x 115	8.7
3300	64 x 115	9.1	64 x 130	9.5	64 x 155	10.2
					77 x 130	10.1
3900	64 x 130	10.4	64 x 155	11.1	64 x 195	12.3
			77 x 115	10.4		
4700	64 x 155	12.2	64 x 196	13.4	77 x 155	12.9
	77 x 155	11.5	77 x 130	12.0		
5600	64 x 195	14.6	64 x 195	14.6	77 x 195	15.4
	77 x 130	13.1	77 x 155	14.0	90 x 157	14.9
6800	77 x 155	15.5	90 x 157	16.5	90 x 196	18.0
8200	90 x 157	18.1	90 x 157	18.1	90 x 196	19.8
10000	90 x 157	19.9	90 x 196	21.7	90 x 236	23.6
12000	90 x 196	23.8	90 x 236	25.8		
15000	90 x 236	28.8				

Ripple Current: 105 °C, 100 Hz or 120 Hz
 Specific capacitance and case sizes are available upon request.