

Part Number	<b>CBB65E-440R156-M1</b>	Revision	
Customer P/N	<b>008-0015</b>	Revision	
Capacitance	<b>15</b>	uF.	Tolerance <b>6.0%</b>
Voltage	<b>440</b>	VAC	
Dielectric	<b>Metallized Polypropylene</b>		
Terminal Type	<b>.250" Quad-Spade Quick Connect Terminals</b>		
Operating Temperature	<b>-40 °C.-</b>	<b>70 °C.</b>	
Dissipation Factor	<b>0.001</b>	maximum	@ 60 Hz.

# MOTOR Capacitors, Inc.

Motor Capacitors, Inc.

335 Beinoris Drive

Wood Dale, Illinois 60191

773-774-6666 (Phone) | 773-774-6690 (Fax)

[www.capacitorindustries.com](http://www.capacitorindustries.com)

[info@capacitorindustries.com](mailto:info@capacitorindustries.com)

	Dimension	Tolerance
Diameter (D) Case/Cover	<b>1.75/1.875</b>	<b>0.03</b>
Case Height (H)	<b>2.96</b>	<b>0.04</b>
Terminal Height (K)	<b>0.56</b>	<b>ref.</b>
Terminal-Terminal (M)	<b>0.81</b>	<b>ref.</b>
Insulating Cup (dia.)	<b>0.74</b>	

*Dimensions in inches*

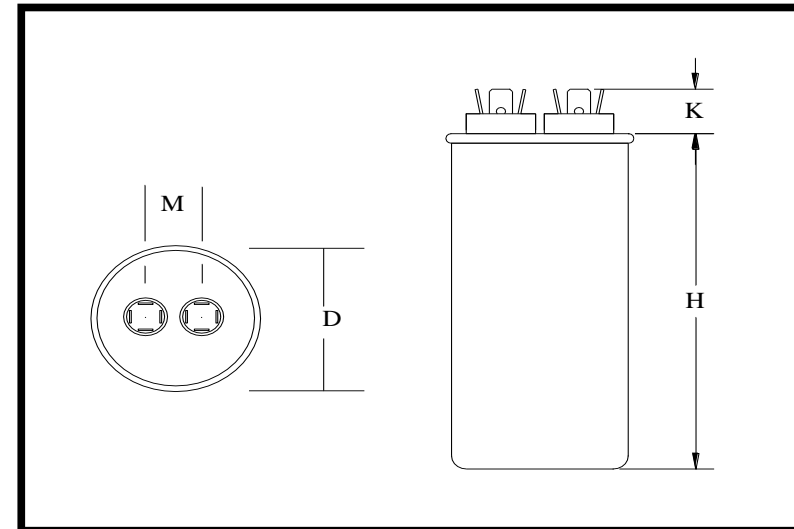

Stamping	Wuxi - Motor Cap
	<b>CBB65E-440R156-M1</b>
	<b>15 uF. 6% 440VAC</b>
	<b>-40 - +70 C. 50/60 Hz.</b>
	<b>008-0015</b>
	<b>S2 Protected 10,000 AFC</b>
<b>Non PCB</b>	<b>RU cRU VDE CE Date Code RoHS</b>

- Meets EIA Standard 456-A
- Rated Life 60,000 Hours
- Agency Approvals: UL, cUL, VDE, CE
- Solid Cover Design; No Fill Hole

Approval : J.D. Aldana  
Date : September 13, 2013