

Part Number	CBB65E-440R1255	Revision	B
Customer P/N	008-0013 / 195-110-0005	Revision	
Capacitance	12.5	uF.	Tolerance 6.0%
Voltage	440	VAC	
Dielectric	Metallized Polypropylene		
Terminal Type	.250" Quad-Spade Quick Connect Terminals		
Operating Temperature	-40 °C.-	70 °C.	
Dissipation Factor	0.001	maximum	@ 60 Hz.

MOTOR Capacitors, Inc.

Motor Capacitors, Inc.
335 Beinoris Drive
Wood Dale, Illinois 60191
773-774-6666 (Phone) | 773-774-6690 (Fax)
www.capacitorindustries.com
info@capacitorindustries.com

	Dimension	Tolerance
Diameter (D) Case/Cover	1.75/1.875	0.03
Case Height (H)	2.62	0.06
Terminal Height (K)	0.56	ref.
Terminal-Terminal (M)	0.81	ref.
Insulating Cup (dia.)	0.74	

Dimensions in inches

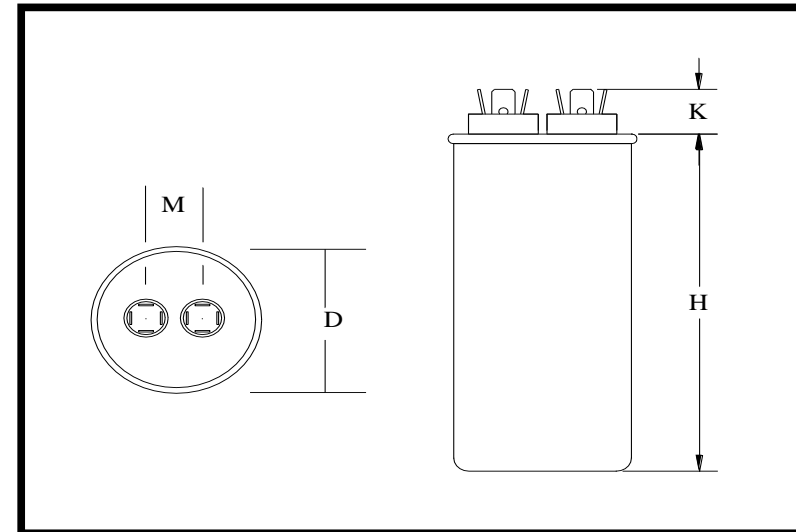

Stamping	Wuxi - Motor Cap
	CBB65E-440R1255
	12.5 uF. 6% 440VAC
	-40 - +70 C. 50/60 Hz.
	008-0013 / 195-110-0005
	S2 Protected 10,000 AFC
Non PCB	RU cRU VDE CE Date Code RoHS

- Meets EIA Standard 456-A
- Rated Life 60,000 Hours
- Agency Approvals: UL, cUL, VDE, CE
- Solid Cover Design; No Fill Hole

Approval : *J.D. Aldana*
Date : July 28, 2014