

Part Number	<b>CBB65-440R605</b>		Revision
Customer P/N			Revision
Capacitance	<b>6</b>	uF.	Tolerance <b>5.0%</b>
Voltage	<b>440</b>	VAC	
Dielectric	<b>Metallized Polypropylene</b>		
Terminal Type	<b>.250" Quad-Spade Quick Connect Terminals</b>		
Operating Temperature	<b>-25 °C.-</b>	<b>85 °C.</b>	
Dissipation Factor	<b>0.001</b>	maximum	@ 60 Hz.

# MOTOR Capacitors, Inc.

**Motor Capacitors, Inc.**  
**335 Beinoris Drive**  
**Wood Dale, Illinois 60191**  
**773-774-6666 (Phone) | 773-774-6690 (Fax)**  
[www.capacitorindustries.com](http://www.capacitorindustries.com)  
[info@capacitorindustries.com](mailto:info@capacitorindustries.com)

	Dimension	Tolerance
Diameter (D) Case/Cover	<b>1.77/1.87</b>	<b>0.06</b>
Case Height (H)	<b>2.15</b>	<b>0.06</b>
Terminal Height (K)	<b>0.56</b>	ref.
Terminal-Terminal (M)	<b>0.81</b>	ref.
Insulating Cup (dia.)	<b>0.74</b>	

*Dimensions in inches*

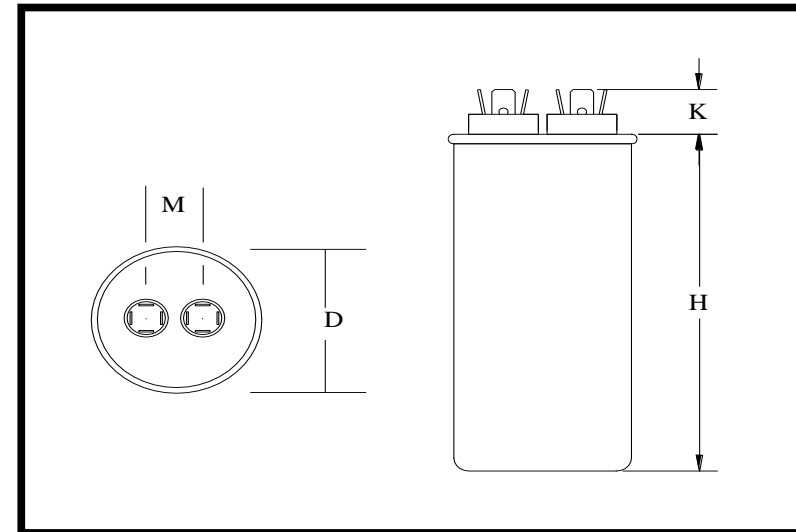

Stamping	<b>Wuxi - Motor Cap</b>		
	<b>CBB65-440R605</b>		
	<b>6uF 5% 440 VAC</b>		
	<b>-25 +85 C. 50/60 Hz.</b>		
	<b>Protected 10,000 AFC</b>		
<b>Non PCB</b>	<b>RU</b>	<b>cRU</b>	<b>Date Code RoHS</b>

Approval : *J.D. Aldana*  
Date : June 23, 2004