

Part Number	CBB65-370R406-M1	Revision	
Customer P/N	16P002D20	Revision	
Capacitance	40	uF.	Tolerance 5.0%
Voltage	370	VAC	
Dielectric	Metallized Polypropylene		
Terminal Type	.250" Quad-Spade Quick Connect Terminals		
Operating Temperature	-40 °C.-	85 °C.	
Dissipation Factor	0.001	maximum	@ 60 Hz.

MOTOR Capacitors, Inc.

Motor Capacitors, Inc.
335 Beinoris Drive
Wood Dale, Illinois 60191
773-774-6666 (Phone) | 773-774-6690 (Fax)
www.capacitorindustries.com
info@capacitorindustries.com

	Dimension	Tolerance
Diameter (D) Case/Cover	1.75	0.06
Case Height (H)	3.75	0.06
Terminal Height (K)	0.56	ref.
Terminal-Terminal (M)	0.81	ref.
Insulating Cup (dia.)	0.74	

Dimensions in inches

Stamping	Wuxi - Motor Cap
	CBB65-370R406-M1
	40uF 5% 370 VAC
	-40 - +85 C. 50/60 Hz.
	Protected 10,000 AFC
Non PCB	RU cRU Date Code RoHS

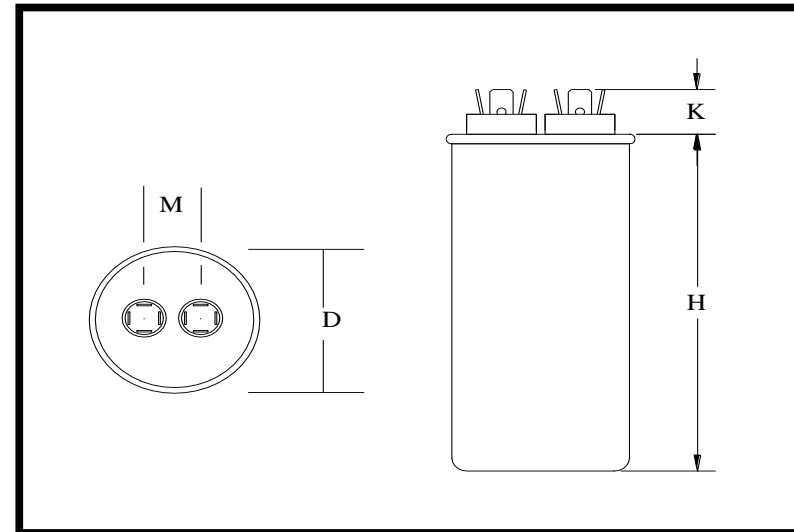

Capacitor must be Bar Code labeled with our P/N CBB65-370R406-M1

Approval : *J.D. Aldana*
Date : March 8, 2006