

Part Number	CBB65-370R306-M5	Revision	
Customer P/N	195-200-1029	Revision	
Capacitance	30	uF.	Tolerance 5.0%
Voltage	370	VAC	
Dielectric	Metallized Polypropylene		
Terminal Type	.250" Quad-Spade Quick Connect Terminals		
Operating Temperature	-40 °C.-	85 °C.	
Dissipation Factor	0.001	maximum	@ 60 Hz.

MOTOR Capacitors, Inc.

Motor Capacitors, Inc.

335 Beinoris Drive

Wood Dale, Illinois 60191

773-774-6666 (Phone) | 773-774-6690 (Fax)

www.capacitorindustries.com

info@capacitorindustries.com

	Dimension	Tolerance
Diameter (D) Case/Cover	1.75/1.86	0.03
Case Height (H)	3.00	0.06
Terminal Height (K)	0.50	ref.
Terminal-Terminal (M)	0.81	ref.
Insulating Cup (dia.)	0.74	

Dimensions in inches

Stamping	Wuxi - Motor Cap			
	CBB65-370R306-M5			
	30uF 5% 370 VAC			
	-40 - +85 C. 50/60 Hz.			
	195-200-1029			
	Protected 10,000 AFC			
Non PCB	RU	cRU	E235355	Date Code RoHS

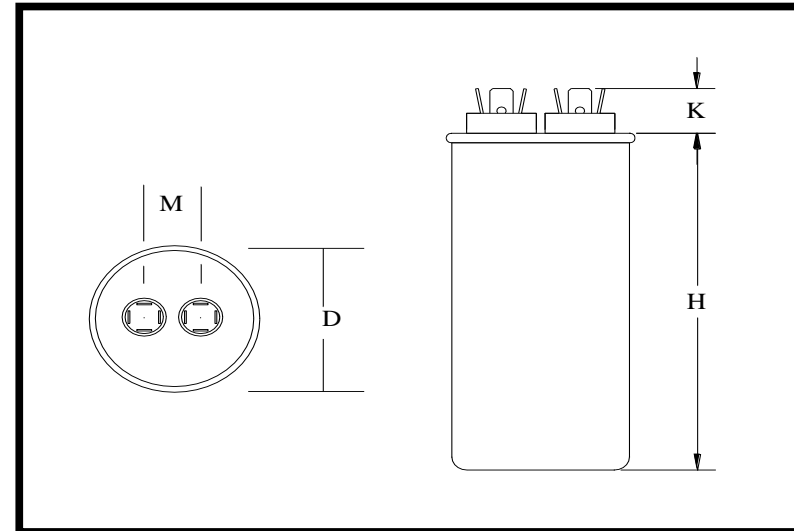

Approval : *J. D. Aldana*
 Date : February 18, 2012

