

Part Number	CBB65-370R07E60	Revision	
Customer P/N	E-0211	Revision	
Capacitance	60 + 7.5	uF.	Tolerance 5%
Voltage	370	VAC	
Dielectric	Metallized Polypropylene		
Terminal Type	.250" Quad-Spade Quick Connect Terminals		
Operating Temperature	-25 oC.-	85 °C.	
Dissipation Factor	0.001	maximum @ 60 Hz.	

MOTOR Capacitors, Inc.

Motor Capacitors, Inc.
 335 Beinoris Drive
 Wood Dale, Illinois 60191
 773-774-6666 (Phone) | 773-774-6690 (Fax)
www.capacitorindustries.com
info@capacitorindustries.com

	Dimension	Tolerance
Case Diameter (D)	2.17/2.27	0.06
Case Height (H)	5.72	0.06
Terminal Height (K)	0.56	ref.
Terminal-Terminal (M)	0.81	ref.
Insulating Cup (dia.)	0.74	

Dimensions in inches

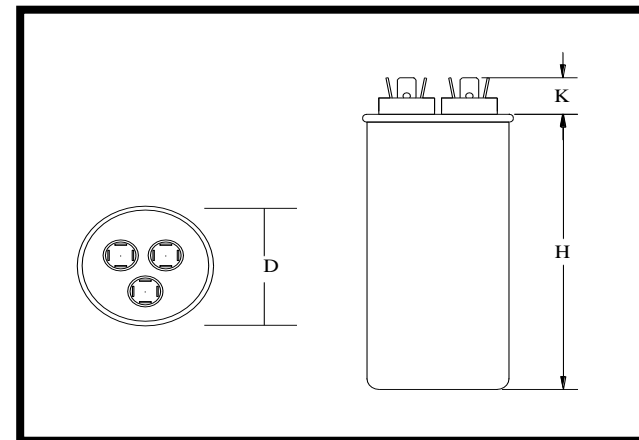

Stamping

Wuxi - Motor Cap
CBB65-370R07E60
60/7.5uF 5% 370 VAC
-25 - +85 C. 50/60 Hz.

RU [®] **US**

Protected 10,000 AFC

Non PCB RU cRU Date Code RoHS

Terminals: Herm (Red-3), Fan (White-1), Common (Black-4)

Approval: *J.D Aldana*
 Date: **September 15, 2002**