

Part Number	CBB65-250R506		Revision
Customer P/N			Revision
Capacitance	50	uF.	Tolerance 5.0%
Voltage	250	VAC	
Dielectric	Metallized Polypropylene		
Terminal Type	.250" Quad-Spade Quick Connect Terminals		
Operating Temperature	-40 °C.-	85 °C.	
Dissipation Factor	0.001	maximum	@ 60 Hz.

MOTOR Capacitors, Inc.

Motor Capacitors, Inc.

335 Beinoris Drive

Wood Dale, Illinois 60191

773-774-6666 (Phone) | 773-774-6690 (Fax)

www.capacitorindustries.com

info@capacitorindustries.com

	Dimension	Tolerance
Diameter (D) Case/Cover	1.97/2.06	0.06
Case Height (H)	2.97	0.06
Terminal Height (K)	0.56	ref.
Terminal-Terminal (M)	0.81	ref.
Insulating Cup (dia.)	0.74	

Dimensions in inches

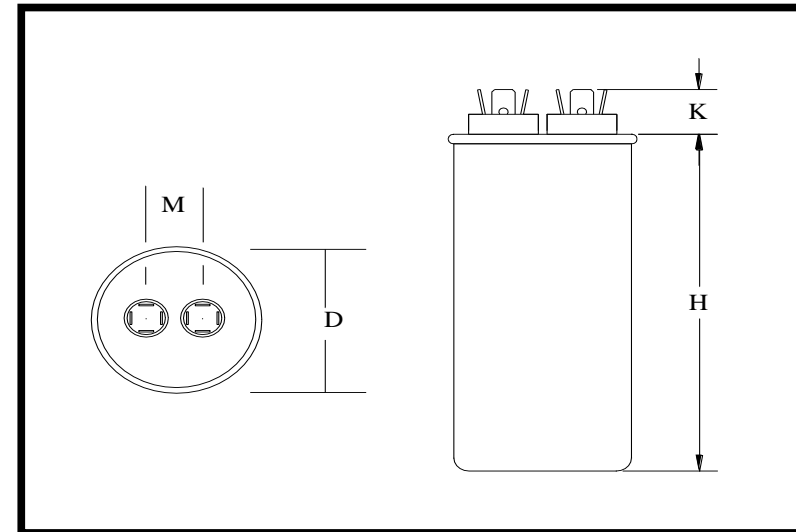

Stamping	Wuxi - Motor Cap			
	CBB65-250R506			
	50uF 5% 250 VAC			
	-25 - +85 C. 50/60 Hz.			
	Protected 10,000 AFC			
Non PCB	RU	cRU	Date Code	RoHS



Approval : J.D. Aldana
Date : February 24, 2004