

Part Number	494-00035-M1	Revision	
Customer P/N	494-00035-M1	Revision	
Capacitance	20	uF.	Tolerance 6.0%
Voltage	370	VAC	
Dielectric	Metalized Polypropylene		
Terminal Type	.250" Dual-Spade Quick Connect Terminals		
Operating Temperature	-25 °C.-	70 °C.	
Dissipation Factor	0.002	maximum	@ 60 Hz.

MOTOR Capacitors, Inc.

Motor Capacitors, Inc.
 335 Beinoris Drive
 Wood Dale, Illinois 60191
 773-774-6666 (Phone) | 773-774-6690 (Fax)
www.capacitorindustries.com
info@capacitorindustries.com

	Dimension	Tolerance
Width (W)	2.16	0.06
Thickness (T)	1.40	0.06
Height (H)	3.41	max.
Terminal Height (K)	0.50	max.
Bracket Length (B)	1.75	ref.
Reference Curve (R)	1.62	max.

Dimensions in inches

Stamping	MOTOR-CAP
	494-00035-M1
	20 uF 370 V
	RU

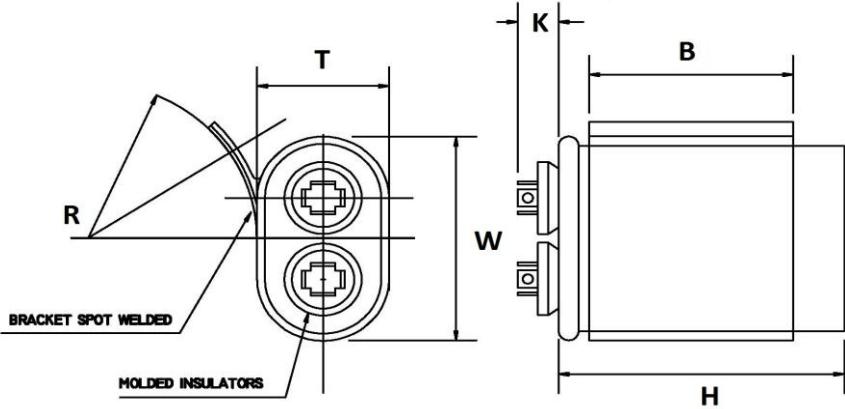

Oil-Filled Tern Plate Steel Case
With Spot Welded Bracket and Molded Insulators
Black Enamel Finish
Both terminals have 2-blades

Approval: J. D. Aldana
 Date: July 5, 2016