

|                       |   |               |                       |
|-----------------------|---|---------------|-----------------------|
| Part Number           | <b>494-00034</b>                                |               | Revision              |
| Customer P/N          | <b>494-00034</b>                                |               | Revision              |
| Capacitance           | <b>15</b>                                       | uF.           | Tolerance <b>6.0%</b> |
| Voltage               | <b>370</b>                                      | VAC           |                       |
| Dielectric            | <b>Metalized Polypropylene</b>                  |               |                       |
| Terminal Type         | <b>.250" Quad-Spade Quick Connect Terminals</b> |               |                       |
| Operating Temperature | <b>-25 °C.-</b>                                 | <b>70 °C.</b> |                       |
| Dissipation Factor    | <b>0.002</b>                                    | maximum       | @ 60 Hz.              |

# MOTOR Capacitors, Inc.

Motor Capacitors, Inc.  
 335 Beinoris Drive  
 Wood Dale, Illinois 60191  
 773-774-6666 (Phone) | 773-774-6690 (Fax)  
[www.capacitorindustries.com](http://www.capacitorindustries.com)  
[info@capacitorindustries.com](mailto:info@capacitorindustries.com)

|                     | Dimension   | Tolerance   |
|---------------------|-------------|-------------|
| Width (W)           | <b>2.91</b> | <b>0.06</b> |
| Thickness (T)       | <b>1.91</b> | <b>0.06</b> |
| Height (H)          | <b>3.00</b> | <b>max.</b> |
| Terminal Height (K) | <b>0.50</b> | <b>max.</b> |
| Bracket Length (B)  | <b>2.12</b> | <b>ref.</b> |
| Reference Curve (R) | <b>2.50</b> | <b>max.</b> |

*Dimensions in inches*

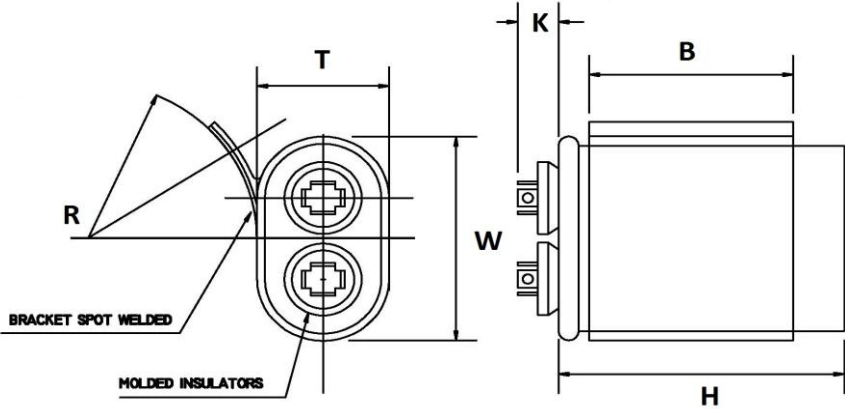

|          |                    |
|----------|--------------------|
| Stamping | <b>MOTOR-CAP</b>   |
|          | <b>494-00034</b>   |
|          | <b>15 uF 370 V</b> |
|          | <b>RU</b>          |

**Oil-Filled Tern Plate Steel Case**  
**With Spot Welded Bracket and Molded Insulators**  
**Black Enamel Finish**

Approval: J. D. Aldana  
 Date **July 5, 2016**