

REVISIONS				
ZONE	REV	DESCRIPTION	DATE	APPROVED

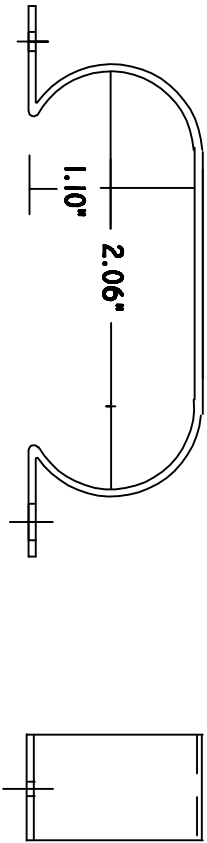
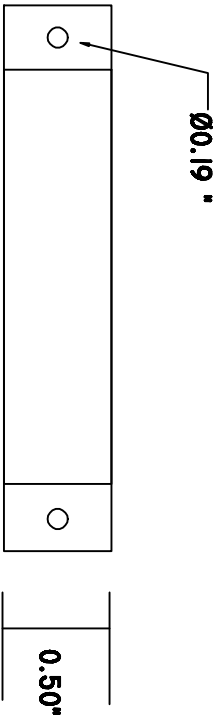

MOUNTING HOLE DIAMETER: 0.19"  
 UNPLATED SHEET THICKNESS: 0.035"  
 MATERIAL: CRS

DIMENSIONS IN INCHES  
 DIMENSIONAL TOLERANCE: +/- 0.03"  
 UNLESS OTHERWISE SPECIFIED

NOTE: ALL DIMENSIONS TO BE MEASURED WHEN  
 BRACKET IS RIGIDLY HELD TO AVOID SPRINGBACK

**MOTOR**  
 Capacitors, Inc.

<b>Motor Capacitors, Inc</b> Division of Capacitor Industries 335 Belmont Drive Wood Dale, IL 60191		HCI Part Number <b>IC1611G</b>	
DRAWING BY: JDGA APPROVED BY: LD		CUSTOMER PART NUMBER -----	
DATE DWG: 03/08/17 SCALE:		DWG NO.: SHEET:	
REV:		REV:	